

PERMIT

CITY OF NAPOLEON, OHIO — DEPT. OF BUILDING & ZONING
255 W. Riverview Avenue, Napoleon, Ohio 43545 (419) 592-4010

Permit No. 354 Date Sept. 18, 1981
Job Location 1112 Sheffield Ave. Valuation \$ 400.00
Owner Ronald L. & Donna F. Bliss Address 644 Meadow Ln.; Wauseon, Oh.
Contractor Self Name Self Telephone No. 337-3730
Address Same
Electric Contractor _____
Plumbing Contractor _____
Mechanical Contractor _____

This permit is issued for work described in the plans, specifications, and/or application submitted, as approved by the Building Commissioner of the City of Napoleon, Ohio. Work shall conform to all pertinent construction and land use Codes and Ordinances.

Work Information:

Residential Commercial _____ Industrial _____
No. dwelling units
New Construction Addition _____ Remodel _____
Brief Description of Work Accessory Building 10 x 10

ISSUED BY Richard G. Haymer J.H.
Building Official

PAID
DEPT. OF BUILDING & ZONING
SEP 18 1981
CITY OF NAPOLEON

It is the owners or contractors responsibility to call the Building Department for the following (x) inspections:

- _____ Footing excavation prior to placing concrete.
- _____ Footing drains and foundation prior to backfill.
- _____ Prepared sub-grade prior to placing concrete floor slab.
- _____ Sanitary sewer
- _____ Rough-in electrical, plumbing and service framing prior to installing wall board.
- _____ Final electrical, plumbing and heating.
- Final building inspection, prior to occupancy.

PERMIT & FEES

Building Permit	\$ <u>3.00</u>
Electrical Permit	\$ _____
Plumbing Permit	\$ _____
Mechanical Permit	\$ _____
Demolition Permit	\$ _____
Zoning Permit	\$ _____
Sign Permit	\$ _____
Water Tap	\$ _____
Sewer Tap	\$ _____
Temp. Elec.	\$ _____
Other TEMP. WATER	\$ _____
TOTAL FEES	\$ <u>3.00</u>
LESS FEES PAID	\$ <u>3.00</u>
BALANCE DUE	\$ <u>-0.00-</u>

Permit is not valid until all fees are paid in full, and shall be void if work is not started within six months of date above.

CITY OF NAPOLEON
 BUILDING INSPECTION DEPARTMENT
 APPLICATION FOR BUILDING PERMIT
 (Please print or type)

The undersigned hereby makes application for construction, installation, or alteration work as herein specified, agreeing to do all such work in strict accordance with the City of Napoleon's adopted Building Codes.

Location of project 1112 SHEFFIELD AVE. Cost of project \$400.00

Owner's Name RONALD L. & DONNA F. BLISS Address 644 MEADOW LAKE WILSON, OH.

Contractor SELF Telephone No. 337 3730

Address SAME AS ABOVE

Lot Information: (Not required for siding job)

Lot No. _____ Subdivision _____

Zoning District A Lot Size 55 ft. X 100 ft. Area 5500 sq. ft.

Setbacks: Front 40' Right Side 37' Left Side 27' Rear 5'

Work Information:

Residential Commercial _____ Industrial _____

New Construction _____ Addition _____ Remodel _____

Accessory Building (STORAGE SHED) Siding PLYWOOD SHEETING
 (Specific Type)

Brief Description of Work: ----- WOOD FRAME 2x4, PLYWOOD SHEETING

ASBESTOS SHINGLED, PITCHED ROOF ON 8" CEMENT BLOCK SUPPORTED CENTER & SIDES

Size: Length 10 FEET Width 10 FEET No. of Stories 1

Area: 1st Floor sq. ft. Basement _____ sq. ft.

2nd Floor _____ sq. ft. Accessory Bldg. 100 sq. ft.

3rd Floor _____ sq. ft. Other _____ sq. ft.

PAID

SEP 18 1981

Additional Information: _____

CITY OF NAPOLEON

APPLICATION FOR PERMIT SHALL BE ACCOMPANIED BY TWO COMPLETE SETS OF PLANS INCLUDING: ELEVATIONS, FLOOR PLANS, CROSS SECTIONS AND PLOT PLAN. IF ADDITION OR REMODELING, SHOW ALL EXISTING STRUCTURES AND THEIR SIZE AND LOCATION. ALL PLANS SHALL BE DRAWN TO SCALE.

Date Sept 18, 1981 Applicant's Signature Ronald L. Bliss

PERMIT NO. 354

PERMIT FEE \$ 3.00

BUILDING DESCRIPTION
10' X 10' STORAGE SHED - 2' X 4' FRAME, PLYWOOD
SHEATHING, PITCHED ROOF WITH ASBESTOS SHINGLES SUPPORTED
CENTER AND SIDES BY 8" CEMENT BLOCK.

1112 SHEFFIELD AVE.

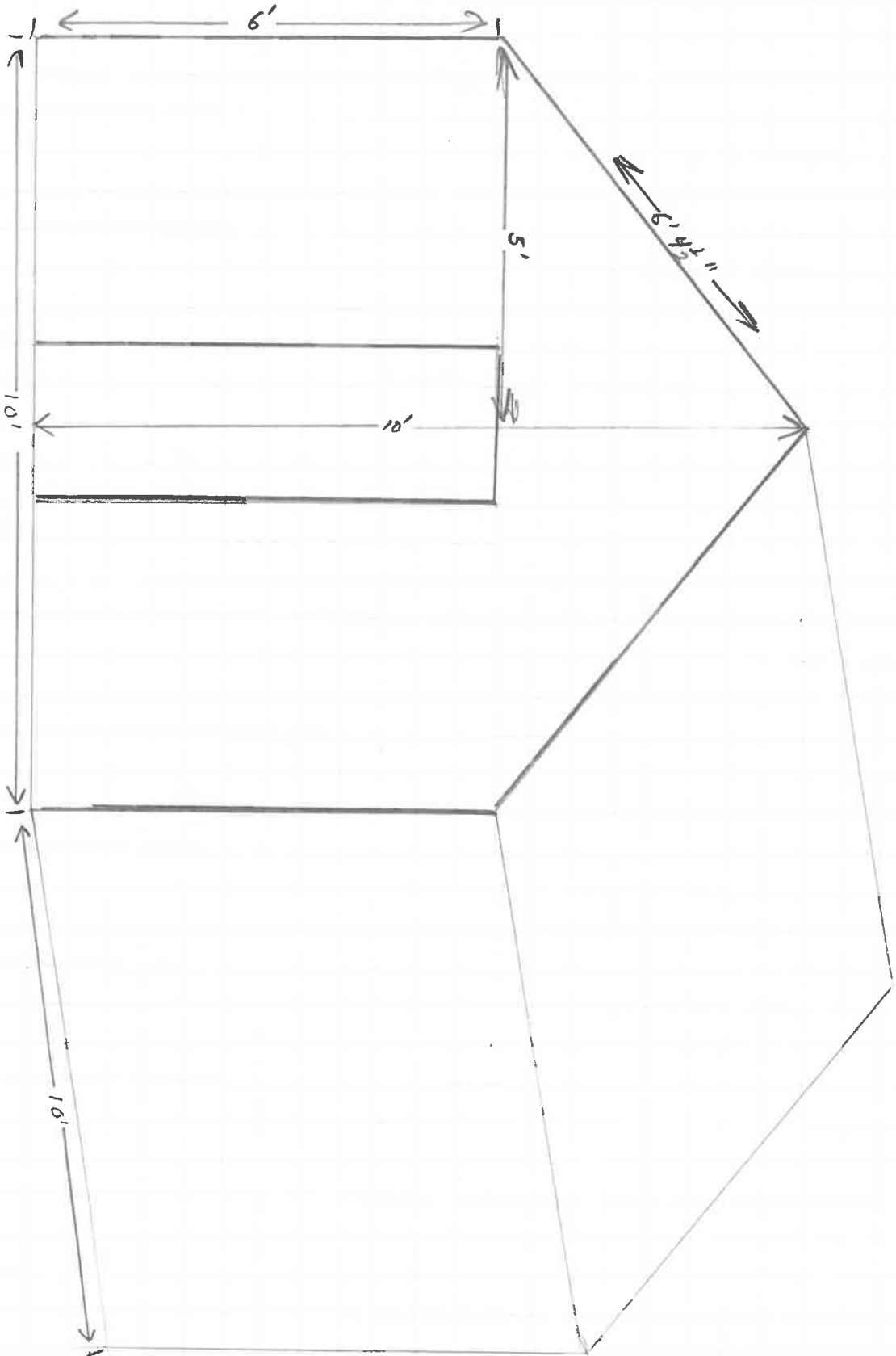

Lot Plan 1112 SHEFFIELD - Construction of Storage Shed
Lot Size 55' x 100'

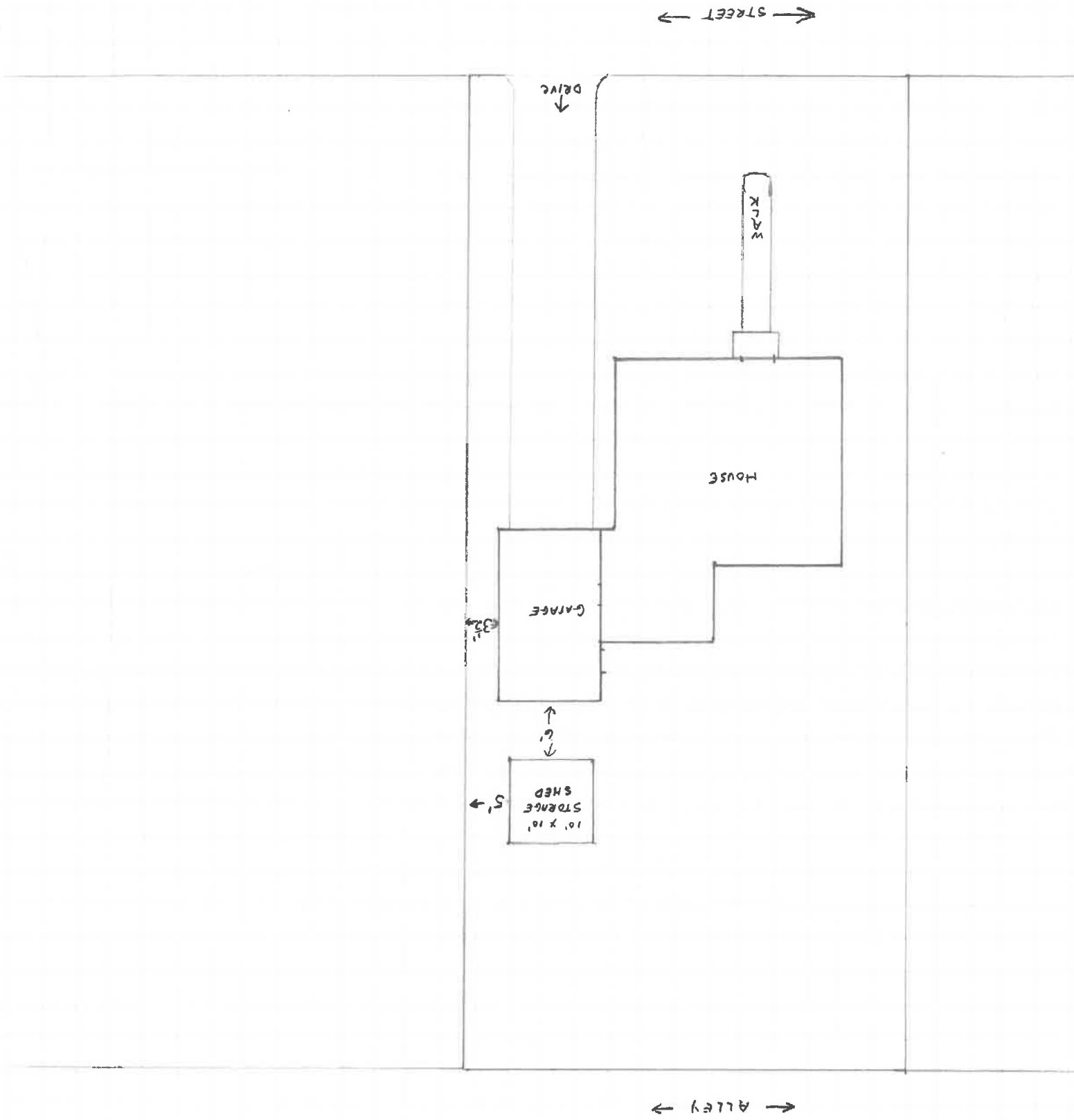

PERMIT

CITY OF NAPOLEON, OHIO — DEPT. OF BUILDING & ZONING

255 W. Riverview Avenue, Napoleon, Ohio 43545 (419) 592-4010

Permit No. 354 Date Sept. 18, 1981

Job Location 1112 Sheffield Ave. Valuation \$ 400.00

Owner Ronald L. & Donna M. Bliss Address 644 Meadow Ln.; Wauseon, Oh.

Contractor Self Name Same Telephone No. 337-3730

Address Same

Electric Contractor _____

Plumbing Contractor _____

Mechanical Contractor _____

This permit is issued for work described in the plans, specifications, and/or application submitted, as approved by the Building Commissioner of the City of Napoleon, Ohio. Work shall conform to all pertinent construction and land use Codes and Ordinances.

Work Information:

Residential Commercial _____ Industrial _____

New Construction Addition _____ Remodel _____

Brief Description of Work _____

ISSUED BY _____ DEPT. OF BUILDING & ZONING

It is the owners or contractors responsibility to call the Building Department for the following (x) inspections:

- _____ Footing excavation prior to placing concrete.
- _____ Footing drains and foundation prior to backfill.
- _____ Prepared sub-grade prior to placing concrete floor slab.
- _____ Sanitary sewer
- _____ Rough-in electrical, plumbing and service framing prior to installing wall board.
- _____ Final electrical, plumbing and heating.
- Final building inspection, prior to occupancy.

PERMIT & FEES

Building Permit	\$ _____
Electrical Permit	\$ <u>1.00</u>
Plumbing Permit	\$ _____
Mechanical Permit	\$ _____
Demolition Permit	\$ _____
Zoning Permit	\$ _____
Sign Permit	\$ _____
Water Tap	\$ _____
Sewer Tap	\$ _____
Temp. Elec.	\$ _____
Other _____	\$ _____
TOTAL FEES	\$ <u>3.00</u>
LESS FEES PAID	\$ <u>-0.00-</u>
BALANCE DUE	\$ _____

SEP 18 1981
CITY OF NAPOLEON

Permit is not valid until all fees are paid in full, and shall be void if work is not started within six months of date above.

INSPECTION RECORD

UNDERGROUND		ROUGH-IN &				FINAL		
Type	Date	By	Type	Date	By	Type	Date	By
PLUMBING	Sewer Connection		Drainage, W. & Vent			Drainage, W. & Vent		
	Building Sewer		Water Piping			Water Heater		
	Water Piping		Condensate Lines			Backflow Prevention		
			Indirect Waste					
ELECTRICAL	Floor Ducts Raceways		Rough Wiring			FINAL APPROVAL		
	Conduits & or Cable		Conduits/ Cable			Electric Mtr. Clearance		
	Grounding & or Bonding		Service Panel/ Switchboard			Signs		
			Subpanels					
			<input type="checkbox"/> Range <input type="checkbox"/> Dryer			FINAL APPROVAL		
			Refrigerant Piping			Duct Insulation		
MECHANICAL	Ducts/ Plenums		Ducts/ Plenums			Chimney(s)		
			Ventilation <input type="checkbox"/> Supply			Furnace(s)		
			<input type="checkbox"/> Exhst.			FINAL APPROVAL		
	Location, Set-backs, Esmt(s)		Wall Construction			Fireplace Chimney		
BUILDING	Excavation		Crawl Space <input type="checkbox"/> Vent <input type="checkbox"/> Access			Attic <input type="checkbox"/> Vent <input type="checkbox"/> Access		
	Footings & Reinforcing		Floor System(s)			Special Insp Reports Rec'd		
	Sub-soil Drain		Roof System			Smoke Detector		
	Foundation Walls		Fire Wall(s)			Demolition (sewer cap)		
	Floor Slab		Roof Cover/ Roof Drain			Building or Structure		
	FINAL APPROVAL BLDG. DEPT.		<i>10/10/05</i>	Certificate of Occupancy Issued		#		